

Discover new opportunities with the **Builder Extreme 2000 PRO** - our most advanced large scale 3D printer yet.



The Extreme 2000 PRO takes large scale 3D printing to the more professional level. With its giant build volume of 700x700x1700 mm (XYZ), it is one of the tallest FDM 3D printers available on the market. The height makes it ideal for professional and industrial use and printing of high quality industrial grade parts, time after time.

Unique design

The Extreme 2000 PRO has been designed efficiently to be able to offer place to all its key features without sacrificing print volume. Despite its huge build area, the Extreme 2000 PRO is optimal for all workspaces. The filament spools and control box are integrated in the closed housing and will open for easy access, when slightly pushing the panels. The 7-inch touch screen is ergonomically placed at a comfortable to use level.

Versatile Dual-Feed extruder

The Dual-Feed extruder has been developed in-house and has only one nozzle. Nevertheless, the machine prints mono-material objects, but also duo-material or multi-coloured printjobs, such as PLA with PVA. The extruder comes with a set of easy to swap nozzles of three different diameters, to influence print quality and printing time:

- 0.4 mm nozzle
- 0.8 mm nozzle
- 1.2 mm nozzle *



- (0.1 – 0.3 mm layer height)
- (0.4 – 0.7 mm layer height)
- (0.8 – 1.0 mm layer height)

* experimental



Printing extremely large parts? Use both extruders in 50% and print with 2 x 4.5 kg spools. By printing two spools at once (9 kg in total), the print quality will improve and the filament needs to be changed rarely, which reduces print time.



Effortless operation – 7-inch touch screen

The responsive, full-colour touch screen makes operating the Builder Extreme easy and effortless. The touch screen allows you to have full adjustment control over the 3D printed part and Builder Extreme. From print speed, temperature to changing filaments – most of the parameters can be changed on the screen. The printer comes also with useful instruction videos about the machine operation and maintenance. Lock the screen with your personal code for safety reasons.

Fully-closed housing

The fully closed housing, together with the heated bed, positively influences the quality of the printed object and also reduces the sound of the machine by 40%. The transparent doors allow you to monitor the printing process at all times. For safety reasons the doors can only be opened when the print is paused. Press the door logo on the touch screen and the doors will automatically open. The Extreme 2000 PRO is ready to incorporate a BOFA air filter, which reduces the occupational risks connected to the gaseous nanoparticles emission associated with melting plastics.

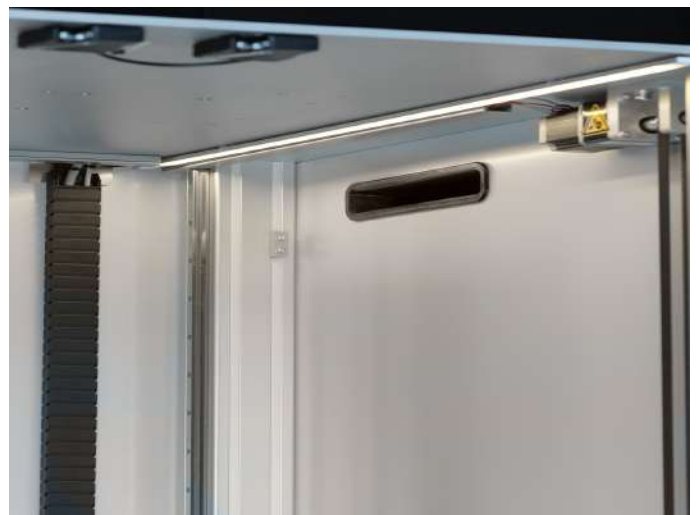





Features that make large scale 3D printing trouble-free

The Builder Extreme comes with an integrated UPS system that resumes the operation after a power cut. When a power failure occurred, the current status will be saved and as soon as the power comes back, you can resume the print. The filament detection kicks in when the machine is running out of filament. After refilling the new spool, you can finish the print job. This also allows you to fully use each spool to reduce leftovers on bigger spools.

Slicing software

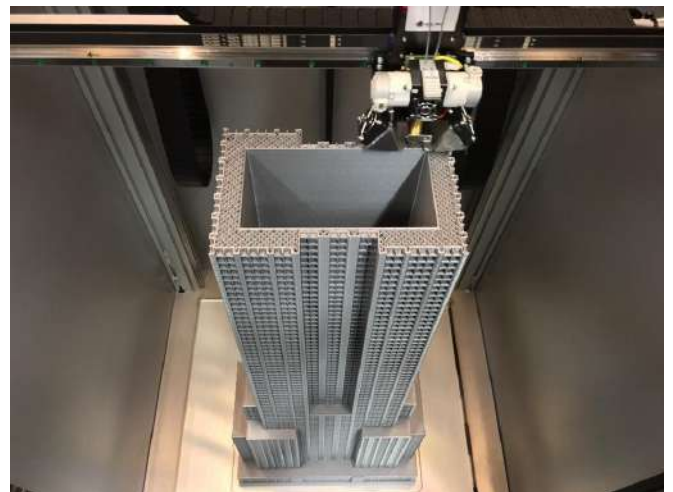
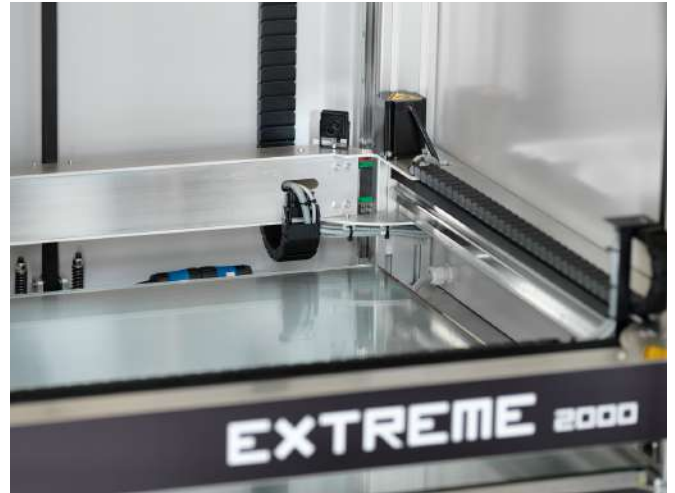
Slicing software is just as important as the 3D printer itself. That is why the Builder Extreme comes with Simplify3D, which is the ideal slicing software for large scale 3D prints. To make a start hassle-free, we already optimised the settings for the different nozzle diameters so you can start printing as soon as the 3D printer arrives.



Key facts	Operating volume	700 x 700 x 1700 mm (XYZ)	
	Print speed	Up to 120 mm/s	
	Layer height resolution	0.1 – 0.9 mm	
	Unique features	Filament detection system Uninterruptible power supply Interchangeable easy-to-swap nozzles Safety door-locking system	
General specifications	Outside dimensions	134 x 105 x 224 cm	
	Shipping dimensions	142 x 110 x 237 cm	
	Weight	250 kg	
	Power rating	1400 W	
	UPS system	Resumes after power outage	
Printing process	Technology	Fused deposition modelling (FDM/FFF)	
	Print head	Mono- or Dual-Feed extruder	
	Print speed	Up to 120 mm/s	
	Travel speed	Up to 200 mm/s	
	Build plate	Heated glass build plate	
	Heated bed	Up to 60°C	
	Levelling	Semi-automatic (auto-levelling expected Q4 of 2019)	
	Feeder type	Direct drive	
Nozzle diameter	0.4 / 0.8 / 1.2 mm		
Control	Connectivity	Wi-Fi, USB port, Ethernet	
	Display	7-inch full colour touch screen	
	On-board camera	Live view from desktop or mobile devices	
	Supplied software	Simplify3D®	
Filaments	Filament diameter	1.75 mm	
	Filament detection	Yes	
	Materials	PLA, PET, PVA, PRO1 (ABS replacement), Flexible filaments	

All specifications might be subjected to changes.